

FOR SUBLEASE

Former Fitness Studio Available Scottsdale Waterfront

SEC Camelback Rd & Marshall Way | Scottsdale, AZ 85251



AVAILABLE



Overview

AVAILABLE FOR SUBLEASE +/- 15,238 SF
RATE Call for Rates

Demographics

	1 MILE	3 MILE	5 MILE
2016 Est Population	12,295	87,976	190,770
2021 Est Population	13,232	93,353	202,011
Average HH Income	\$75,694	\$81,958	\$80,469
Daytime Population	59,354	101,097	197,027

Year: 2016 | Source: Esri

Traffic Counts

Camelback Road	24,288 VPD
Scottsdale Road	33,160 VPD

Year: 2015 | Source: MPSI

Contact

ROBBIE PETTY
602.682.6025 | robbie.petty@srsre.com

ED BEEH
602.682.6040 | ed.beeh@srsre.com

Description

- Former fitness studio available for sublease - space can be converted to retail or office
- Located at the Scottsdale Waterfront: a mixed use development with high-end dining, retail shops, condominiums and offices
- Across the street from Fashion Square Mall, in the heart of Old Town Scottsdale; surrounded by over 3.5 Million SF of retail
- Strong daytime population with over 59,000 employees within a 1 mile radius
- Nearby tenants include:



Former Fitness Studio Available Scottsdale Waterfront

SEC Camelback Rd & Marshall Way | Scottsdale, AZ 85251

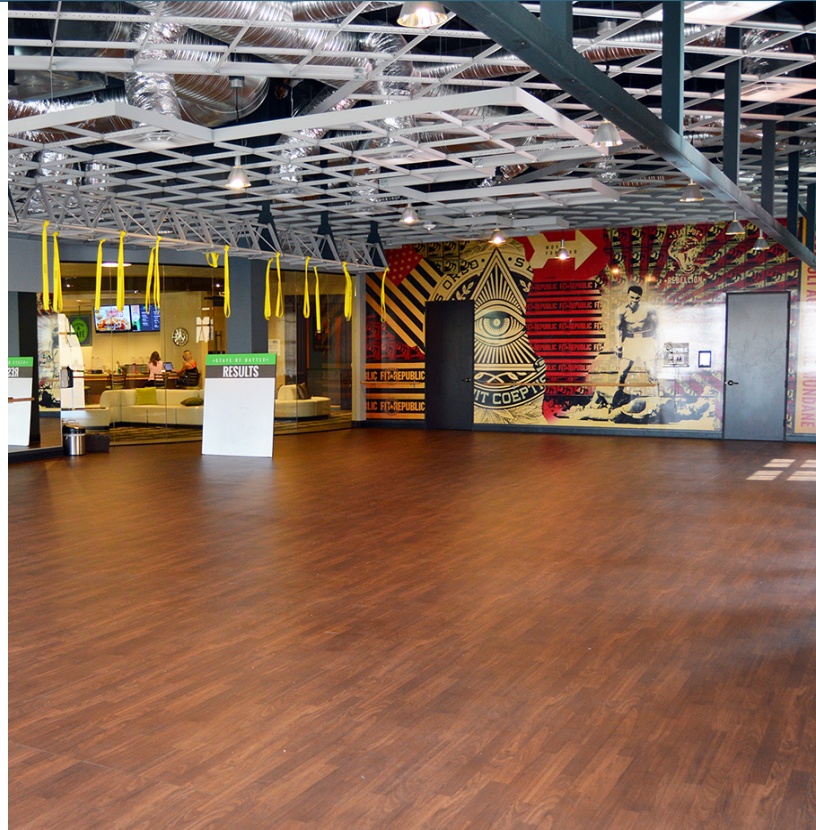

Camelback Road & Scottsdale Road

Scottsdale, Arizona 85251

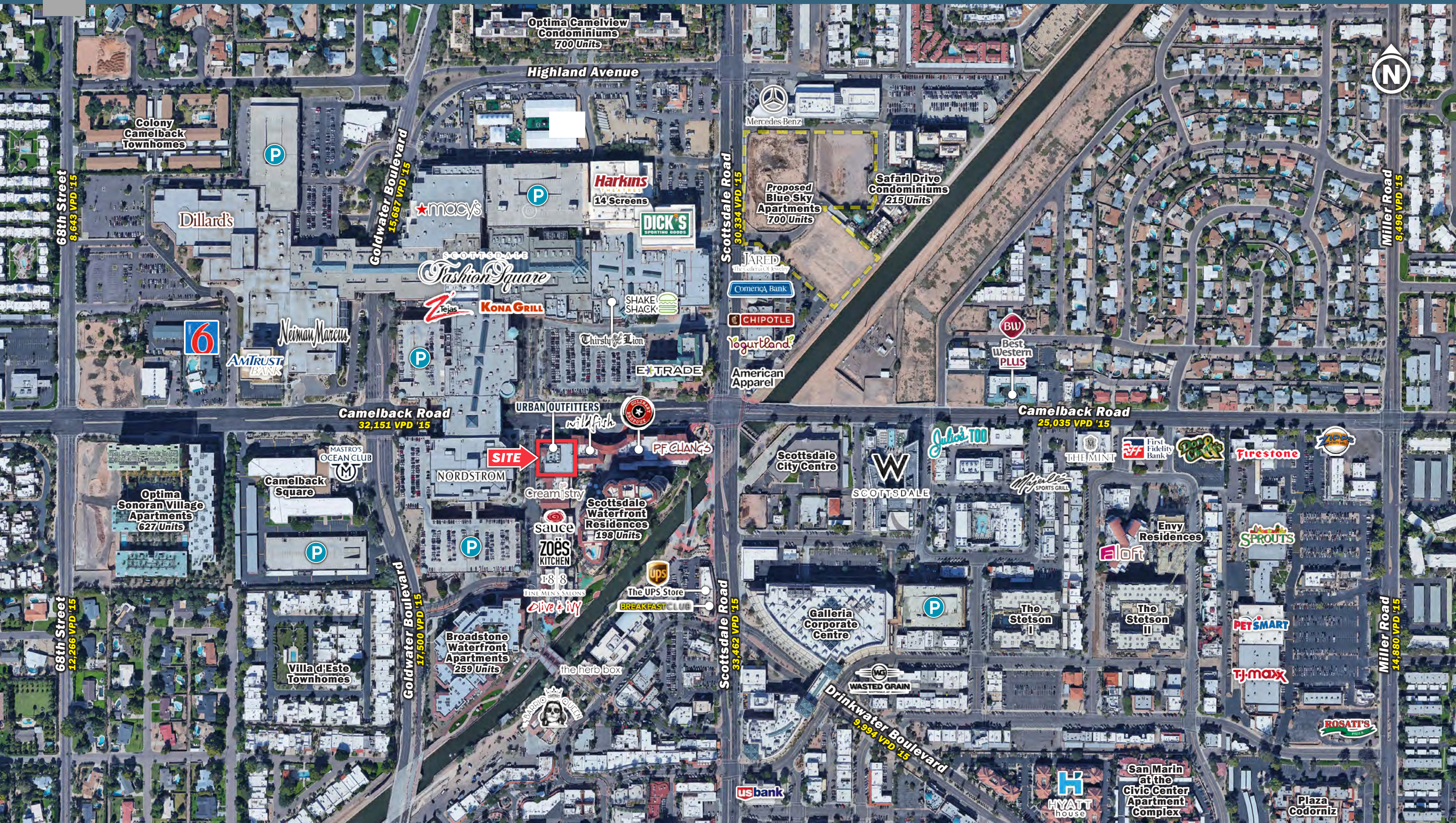

Camelback Road & Scottsdale Road

Scottsdale, Arizona | Trade Area

