

# [ MID RIVERS PLAZA ]

## St. Peters, Missouri



### Contact Information:

Gary Grewe

314.962.6300

gary@gjgrewe.com

### MID RIVERS PLAZA

Mid Rivers Plaza is a fantastic center for regional and national tenants alike. Located across from Mid Rivers Mall, the tenants in the shopping center cannot be found anywhere else in the St. Charles area, making it a desirable location for large and small tenants. Mid Rivers Plaza is visible by over 145,000 vehicles a day from I-70 and several tenants within the center have expanded their size.

#### Current tenants include:



### Intersection of I-70 & Mid Rivers Mall Dr.

St. Peters, MO

#### [DEMOGRAPHICS]

	1-Mile Radius	3-Mile Radius	5-Mile Radius
Med. Household Income	\$53,138	\$72,424	\$72,243
Total Population	8,462	54,762	148,960
Daytime Employment	11,331	24,282	55,746

#### [AVERAGE DAILY TRAFFIC]

Interstate 70	145,748 VPD
Mid Rivers Mall Dr.	33,557 VPD

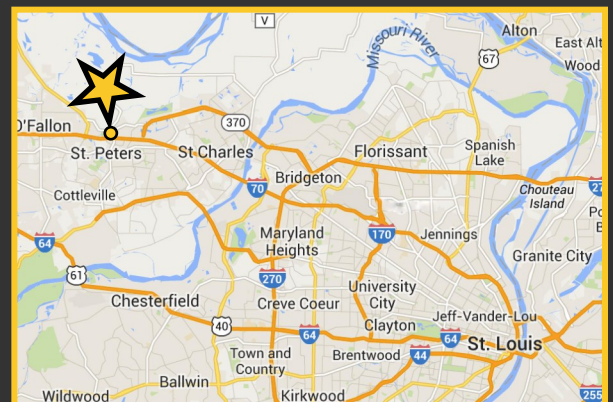

### GOOD NEWS FOR PEOPLE ON THE GROW.

G.J. Grewe, Inc. 9109 Watson Rd., 4th Floor, St. Louis, MO 63126  
www.gjgrewe.com

# [ MID RIVERS PLAZA ]

## St. Peters, Missouri

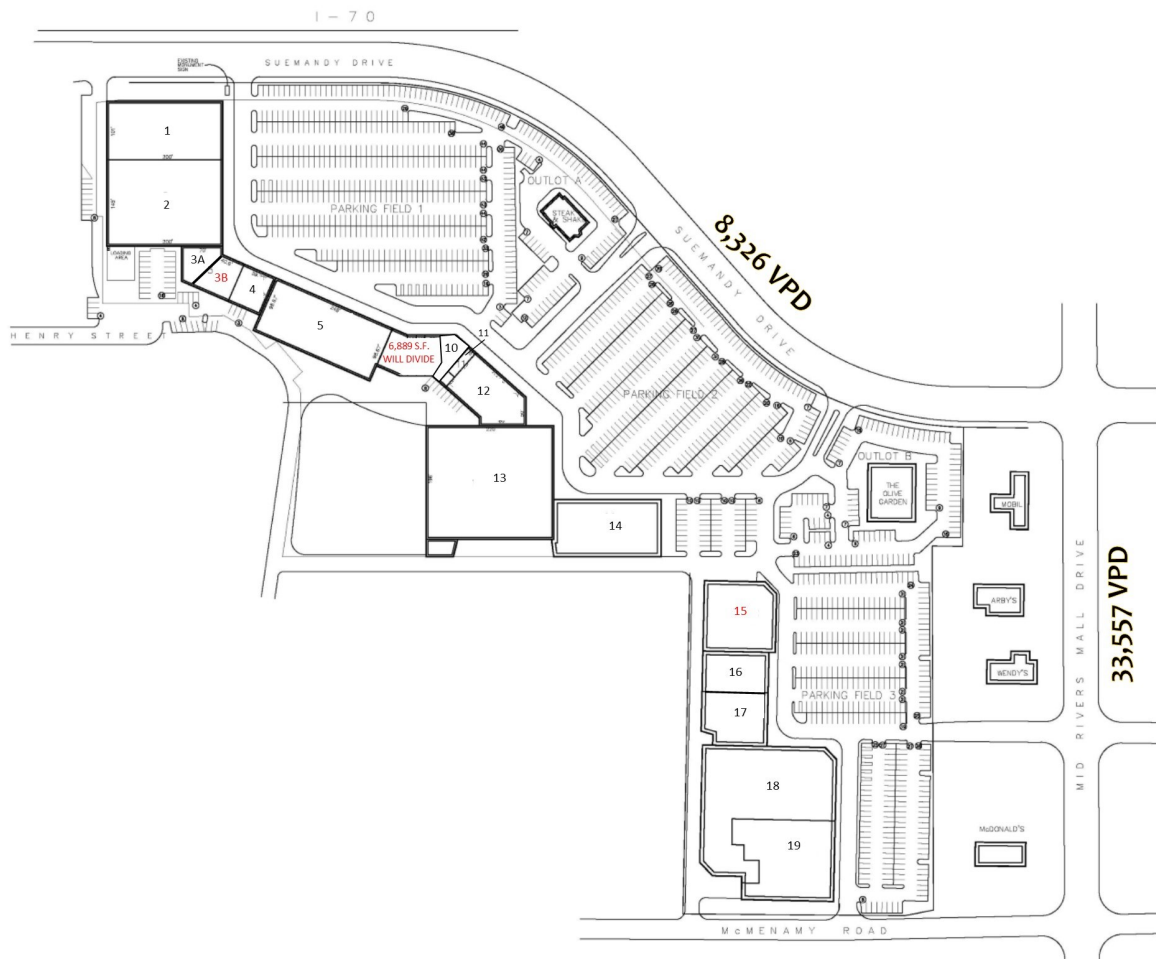

### RETAIL SPACE

1.	Tile Shop	20,200 S.F.
2.	Big Lots	29,800 S.F.
3A	Call Center	4,199 S.F.
3B	Available	2,869 S.F.
4.	Dentures & Dental Services	4,185 S.F.
5.	Chuck's Boots	21,690 S.F.
6-9.	Available (Will Divide)	6,889 S.F.
10.	Painting With A Twist	2,311 S.F.
11.	Diverse Cuts	864 S.F.
12.	Total Hockey Superstore	10,277 S.F.
13.	Toys "R" Us	44,620 S.F.
14.	Johnny Mac's Sporting Goods	18,248 S.F.
15.	Available	15,000 S.F.
16.	DXL	8,000 S.F.
17.	Rally House	9,968 S.F.
18.	Bed Bath & Beyond	38,843 S.F.
19.	Party City	15,795 S.F.

### OUTLOTS

- A Steak 'N Shale
- B Olive Garden

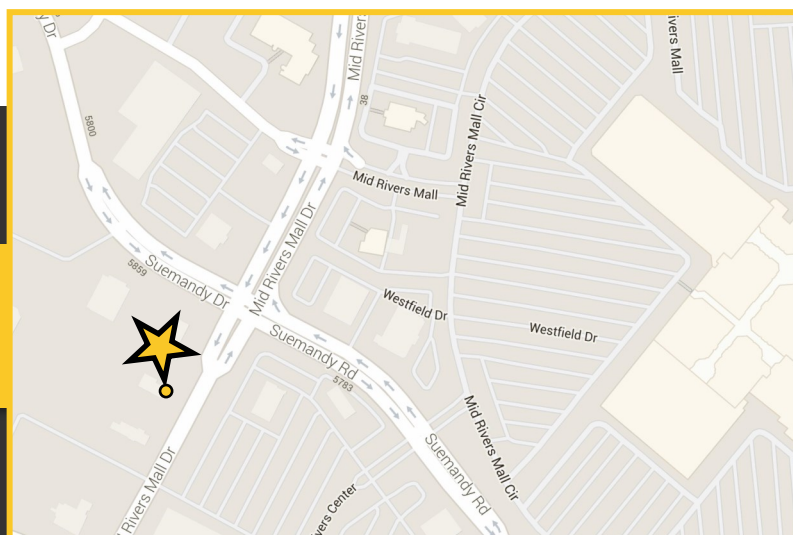

**Contact Information:**  
**Gary Grewe**  
**314.962.6300**  
**gary@gjgrewe.com**

**GOOD NEWS FOR PEOPLE ON THE GROW.**

**G.J. Grewe, Inc. 9109 Watson Rd., 4th Floor, St. Louis, MO 63126**  
**www.gjgrewe.com**