

AVAILABLE

1606 E. University Drive, #107
11,684 Sq. Ft.

Features:

- Located just min. from I-10 & I-17 freeways
- 3,000 sq. ft. a/c office area (Rec, 7 offices, conference room, bullpen, kitchen & 2 r/r)
- 1,000 sq. ft. +/- AIR-CONDITIONED dropped ceiling production room.
- 7,600 sq. ft. +/- Evap cooled warehouse.
- 16' Minimum clear height
- Two (2) 12' x 12' grade doors
- A-2 Zoning, City of Phoenix
- Shared Truckwell
- 400 amps, 277/480 volt, 3 phase power
- Building Signage
- **Competitive Gross Rental Rates**



5100 N. 40th Street
Phoenix, Arizona 85018
(602) 438-8000
(602) 438-7940 fax
www.azindprop.com

For More Information Contact:

Randy S. Warner
(602) 438-8000

randy@azindprop.com

5% Commission - Flat Lease Rates

The information contained herein has been obtained from sources we deem reliable. However, no warranties or representations, expressed or implied, are made as to the accuracy of any information contained herein, and the information is subject to errors and omissions. This information is also subject to change of price, rental or other conditions, withdrawal without notice, and to any special listing conditions imposed by our principals.

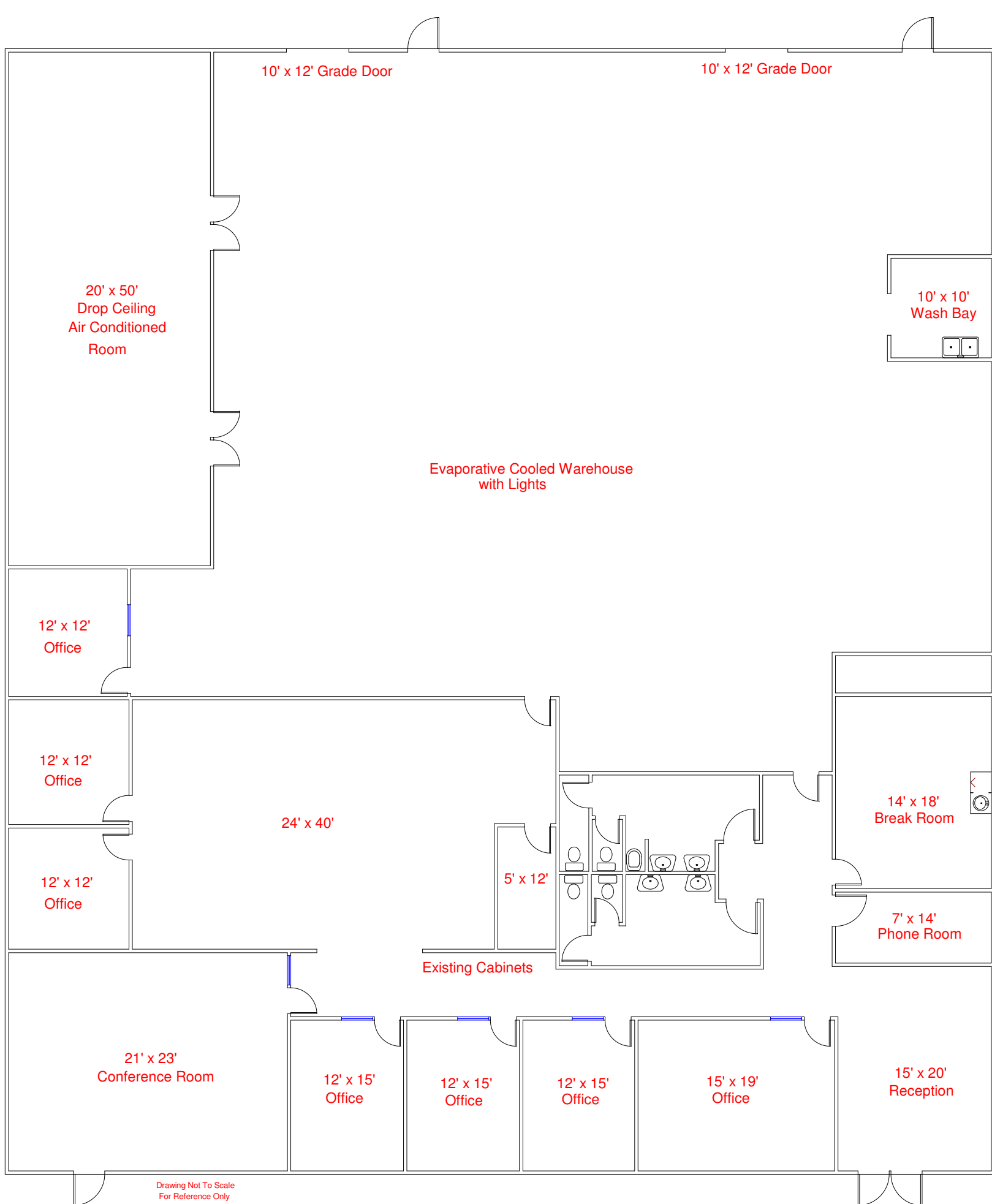

1606 E. University Dr., Ste. 107
Approx. 11,684 Sq. Ft.