

LAKE SUCCESS SHOPPING CENTER ANCHOR OPPORTUNITY

UNION TURNPIKE | NEW HYDE PARK, NY 11040

PROPERTY INFORMATION

ADDRESS: 1468 Union Turnpike
New Hyde Park, NY 11040

PARKING: 1,285 spaces

SIZE: 30,377 SF (Grade Level)
41,302 SF (Lower Level)
34,865 SF (Upper Level)
(Divisions Considered)

COMMENTS:

- Busiest Shopping Center within a 5-Mile Radius
- Strong Co-Tenancy
- Excellent Demographics

POSSESSION: December 2019

ASKING RENT: Upon Request

JOIN







and many other national brands



Demographics	1 mile	3 miles	5 miles
Population	29,002	241,810	684,521
Total Households	9,480	81,733	225,503
Average Household Income	\$138,992	\$121,057	\$117,737
Total Employees	43,911	136,592	316,958



CONTACT EXCLUSIVE BROKERS FOR DETAILS

JESSICA VILMENAY
Executive Managing Director
LIC. Associate RE Broker
jessica@schuckmanrealty.com

KENNETH SCHUCKMAN
President | LIC. RE Broker
ken@schuckmanrealty.com

1983 MARCUS AVENUE, SUITE 102 / LAKE SUCCESS, NY 11042
65 CHALLENGER ROAD, SUITE 305 / RIDGEFIELD PARK, NJ 07660

WWW.SCHUCKMANREALTY.COM
P. 516.496.8888

This information contained herein has been obtained from sources believed reliable. However, we have not verified it and make no guarantee, warranty or representation about it. It is submitted subject to the possibility of errors, omissions, change of price, rental and other conditions, prior sale, lease or financing, or withdrawal without notice. It is your responsibility to independently confirm its accuracy and completeness. Any projections, opinions, assumptions, or estimates used are for example only and they may not represent the current or future suitability, availability or performance of the property. You and your tax and legal advisors should conduct your own investigation of any property and transaction. We may or may not have an exclusive or nonexclusive contractual relationship with a tenant or the owner/landlord of a particular property; and if we do, such relationship shall be fully disclosed to you on a timely basis. Third-party trademarks, service marks, graphics, and logos belong to third parties. You are not granted any right or license with respect to Schuckman Realty Inc.'s trademarks service marks, graphics, and logos or the trademarks service marks, graphics, and logos of any third party. Kenneth Schuckman is Broker of record of Schuckman Realty Inc.

LAKE SUCCESS SHOPPING CENTER ANCHOR OPPORTUNITY

1468 UNION TURNPIKE | NEW HYDE PARK, NY 11040



1983 MARCUS AVENUE, SUITE 102 / LAKE SUCCESS, NY 11042
65 CHALLENGER ROAD, SUITE 305 / RIDGEFIELD PARK, NJ 07660

WWW.SCHUCKMANREALTY.COM
P. 516.496.8888

This information contained herein has been obtained from sources believed reliable. However, we have not verified it and make no guarantee, warranty or representation about it. It is submitted subject to the possibility of errors, omissions, change of price, rental and other conditions, prior sale, lease or financing, or withdrawal without notice. It is your responsibility to independently confirm its accuracy and completeness. Any projections, opinions, assumptions, or estimates used are for example only and they may not represent the current or future suitability, availability or performance of the property. You and your tax and legal advisors should conduct your own investigation of any property and transaction. We may or may not have an exclusive or nonexclusive contractual relationship with a tenant or the owner/landlord of a particular property; and if we do, such relationship shall be fully disclosed to you on a timely basis. Third-party trademarks, service marks, graphics, and logos belong to third parties. You are not granted any right or license with respect to Schuckman Realty Inc.'s trademarks service marks, graphics, and logos or the trademarks service marks, graphics, and logos of any third party. Kenneth Schuckman is Broker of record of Schuckman Realty Inc.

LAKE SUCCESS SHOPPING CENTER ANCHOR OPPORTUNITY

UNION TURNPIKE | NEW HYDE PARK, NY 11040

SHOPPING CENTER MAP

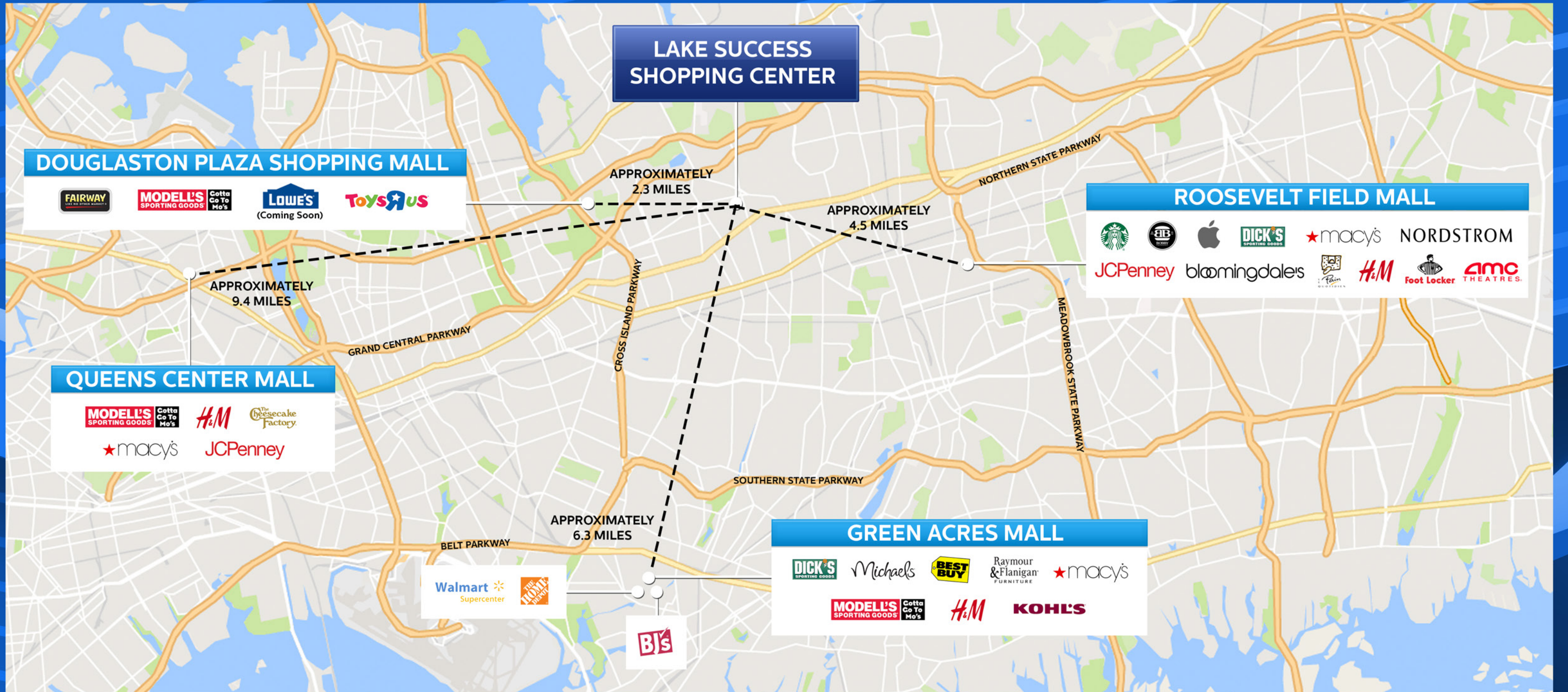

CONTACT EXCLUSIVE BROKERS FOR DETAILS

JESSICA VILMENAY
 Executive Managing Director
 LIC. Associate RE Broker
 jessica@schuckmanrealty.com

KENNETH SCHUCKMAN
 President | LIC. RE Broker
 ken@schuckmanrealty.com

1983 MARCUS AVENUE, SUITE 102 / LAKE SUCCESS, NY 11042
 65 CHALLENGER ROAD, SUITE 305 / RIDGEFIELD PARK, NJ 07660

WWW.SCHUCKMANREALTY.COM
 P. 516.496.8888

This information contained herein has been obtained from sources believed reliable. However, we have not verified it and make no guarantee, warranty or representation about it. It is submitted subject to the possibility of errors, omissions, change of price, rental and other conditions, prior sale, lease or financing, or withdrawal without notice. It is your responsibility to independently confirm its accuracy and completeness. Any projections, opinions, assumptions, or estimates used are for example only and they may not represent the current or future suitability, availability or performance of the property. You and your tax and legal advisors should conduct your own investigation of any property and transaction. We may or may not have an exclusive or nonexclusive contractual relationship with a tenant or the owner/landlord of a particular property; and if we do, such relationship shall be fully disclosed to you on a timely basis. Third-party trademarks, service marks, graphics, and logos belong to third parties. You are not granted any right or license with respect to Schuckman Realty Inc's trademarks service marks, graphics, and logos or the trademarks service marks, graphics, and logos of any third party. Kenneth Schuckman is Broker of record of Schuckman Realty Inc.

LAKE SUCCESS SHOPPING CENTER ANCHOR OPPORTUNITY

UNION TURNPIKE | NEW HYDE PARK, NY 11040

RENDERING



SCHUCKMAN
REALTY INC.

CONTACT EXCLUSIVE BROKERS FOR DETAILS

JESSICA VILMENAY
Executive Managing Director
LIC. Associate RE Broker
jessica@schuckmanrealty.com

KENNETH SCHUCKMAN
President | LIC. RE Broker
ken@schuckmanrealty.com

1983 MARCUS AVENUE, SUITE 102 / LAKE SUCCESS, NY 11042
65 CHALLENGER ROAD, SUITE 305 / RIDGEFIELD PARK, NJ 07660

WWW.SCHUCKMANREALTY.COM
P. 516.496.8888

This information contained herein has been obtained from sources believed reliable. However, we have not verified it and make no guarantee, warranty or representation about it. It is submitted subject to the possibility of errors, omissions, change of price, rental and other conditions, prior sale, lease or financing, or withdrawal without notice. It is your responsibility to independently confirm its accuracy and completeness. Any projections, opinions, assumptions, or estimates used are for example only and they may not represent the current or future suitability, availability or performance of the property. You and your tax and legal advisors should conduct your own investigation of any property and transaction. We may or may not have an exclusive or nonexclusive contractual relationship with a tenant or the owner/landlord of a particular property; and if we do, such relationship shall be fully disclosed to you on a timely basis. Third-party trademarks, service marks, graphics, and logos belong to third parties. You are not granted any right or license with respect to Schuckman Realty Inc.'s trademarks service marks, graphics, and logos or the trademarks service marks, graphics, and logos of any third party. Kenneth Schuckman is Broker of record of Schuckman Realty Inc.

LAKE SUCCESS SHOPPING CENTER ANCHOR OPPORTUNITY

UNION TURNPIKE | NEW HYDE PARK, NY 11040

RENDERINGS



FRONT VIEW



RIGHT VIEW

SCHUCKMAN
REALTY INC.

CONTACT EXCLUSIVE BROKERS FOR DETAILS

JESSICA VILMENAY
Executive Managing Director
LIC. Associate RE Broker
jessica@schuckmanrealty.com

KENNETH SCHUCKMAN
President | LIC. RE Broker
ken@schuckmanrealty.com

1983 MARCUS AVENUE, SUITE 102 / LAKE SUCCESS, NY 11042
65 CHALLENGER ROAD, SUITE 305 / RIDGEFIELD PARK, NJ 07660

WWW.SCHUCKMANREALTY.COM
P. 516.496.8888

This information contained herein has been obtained from sources believed reliable. However, we have not verified it and make no guarantee, warranty or representation about it. It is submitted subject to the possibility of errors, omissions, change of price, rental and other conditions, prior sale, lease or financing, or withdrawal without notice. It is your responsibility to independently confirm its accuracy and completeness. Any projections, opinions, assumptions, or estimates used are for example only and they may not represent the current or future suitability, availability or performance of the property. You and your tax and legal advisors should conduct your own investigation of any property and transaction. We may or may not have an exclusive or nonexclusive contractual relationship with a tenant or the owner/landlord of a particular property; and if we do, such relationship shall be fully disclosed to you on a timely basis. Third-party trademarks, service marks, graphics, and logos belong to third parties. You are not granted any right or license with respect to Schuckman Realty Inc.'s trademarks service marks, graphics, and logos or the trademarks service marks, graphics, and logos of any third party. Kenneth Schuckman is Broker of record of Schuckman Realty Inc.

LAKE SUCCESS SHOPPING CENTER ANCHOR OPPORTUNITY

UNION TURNPIKE | NEW HYDE PARK, NY 11040

SITE PLAN

Anchor Position Opportunity

118,000 SF on Three Levels

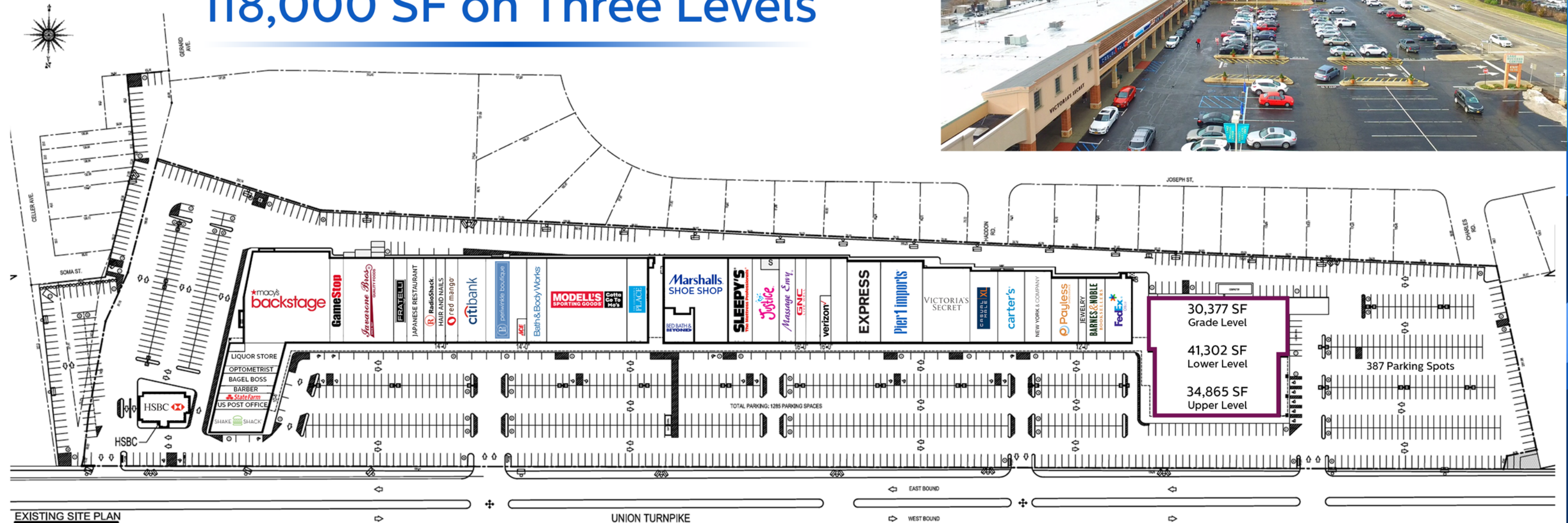

CONTACT EXCLUSIVE BROKERS FOR DETAILS

JESSICA VILMENAY
Executive Managing Director
LIC. Associate RE Broker
jessica@schuckmanrealty.com

KENNETH SCHUCKMAN
President | LIC. RE Broker
ken@schuckmanrealty.com

1983 MARCUS AVENUE, SUITE 102 / LAKE SUCCESS, NY 11042
65 CHALLENGER ROAD, SUITE 305 / RIDGEFIELD PARK, NJ 07660

WWW.SCHUCKMANREALTY.COM
P. 516.496.8888

This information contained herein has been obtained from sources believed reliable. However, we have not verified it and make no guarantee, warranty or representation about it. It is submitted subject to the possibility of errors, omissions, change of price, rental and other conditions, prior sale, lease or financing, or withdrawal without notice. It is your responsibility to independently confirm its accuracy and completeness. Any projections, opinions, assumptions, or estimates used are for example only and they may not represent the current or future suitability, availability or performance of the property. You and your tax and legal advisors should conduct your own investigation of any property and transaction. We may or may not have an exclusive or nonexclusive contractual relationship with a tenant or the owner/landlord of a particular property; and if we do, such relationship shall be fully disclosed to you on a timely basis. Third-party trademarks, service marks, graphics, and logos belong to third parties. You are not granted any right or license with respect to Schuckman Realty Inc.'s trademarks service marks, graphics, and logos or the trademarks service marks, graphics, and logos of any third party. Kenneth Schuckman is Broker of record of Schuckman Realty Inc.

LAKE SUCCESS SHOPPING CENTER ANCHOR OPPORTUNITY

UNION TURNPIKE | NEW HYDE PARK, NY 11040

SITE PLAN | LOWER LEVEL

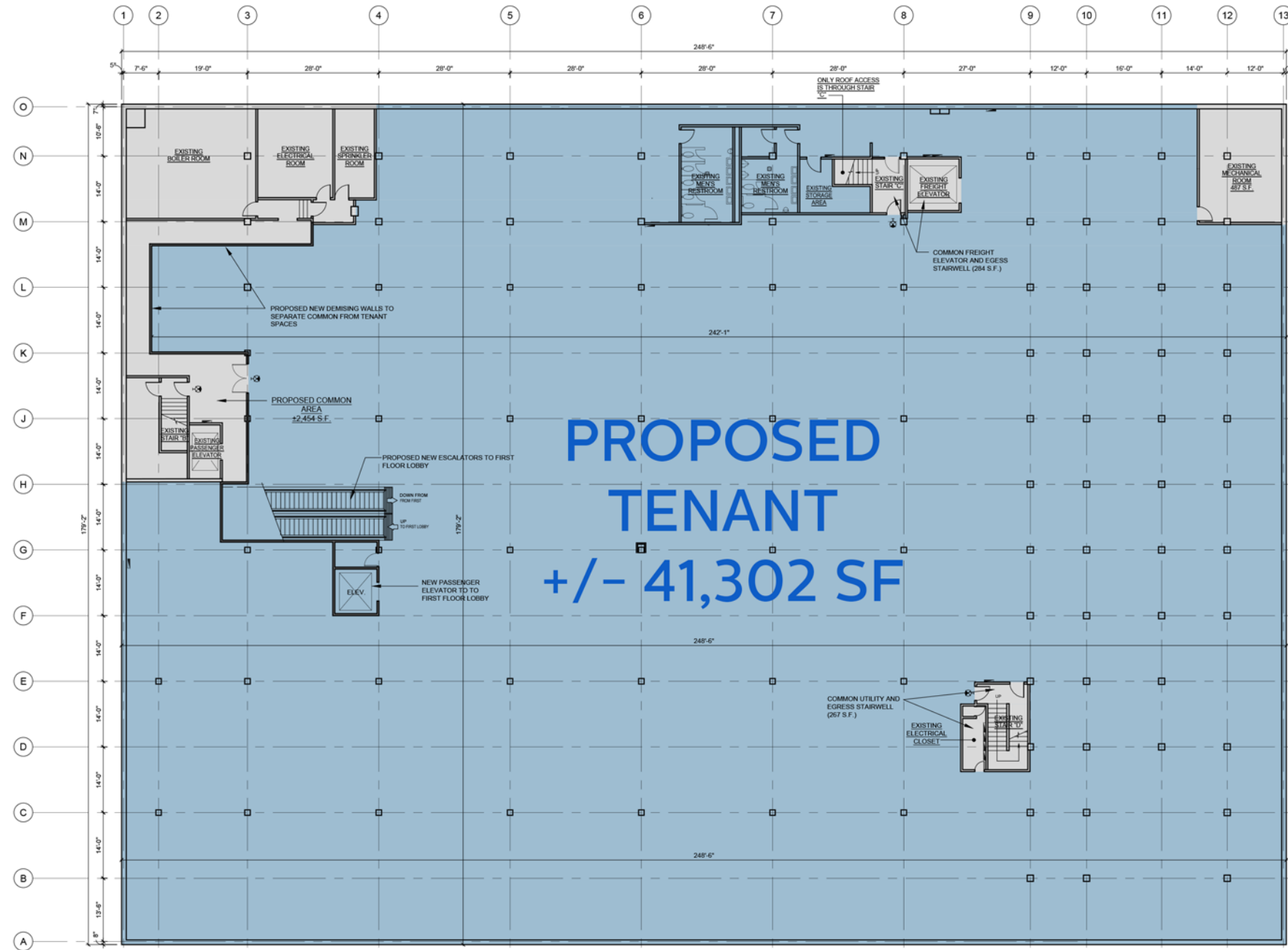

SCHUCKMAN
REALTY INC.

CONTACT EXCLUSIVE BROKERS FOR DETAILS
JESSICA VILMENAY
Executive Managing Director
LIC. Associate RE Broker
jessica@schuckmanrealty.com
KENNETH SCHUCKMAN
President | LIC. RE Broker
ken@schuckmanrealty.com

1983 MARCUS AVENUE, SUITE 102 / LAKE SUCCESS, NY 11042
65 CHALLENGER ROAD, SUITE 305 / RIDGEFIELD PARK, NJ 07660

WWW.SCHUCKMANREALTY.COM
P. 516.496.8888

This information contained herein has been obtained from sources believed reliable. However, we have not verified it and make no guarantee, warranty or representation about it. It is submitted subject to the possibility of errors, omissions, change of price, rental and other conditions, prior sale, lease or financing, or withdrawal without notice. It is your responsibility to independently confirm its accuracy and completeness. Any projections, opinions, assumptions, or estimates used are for example only and they may not represent the current or future suitability, availability or performance of the property. You and your tax and legal advisors should conduct your own investigation of any property and transaction. We may or may not have an exclusive or nonexclusive contractual relationship with a tenant or the owner/landlord of a particular property; and if we do, such relationship shall be fully disclosed to you on a timely basis. Third-party trademarks, service marks, graphics, and logos belong to third parties. You are not granted any right or license with respect to Schuckman Realty Inc.'s trademarks service marks, graphics, and logos or the trademarks service marks, graphics, and logos of any third party. Kenneth Schuckman is Broker of record of Schuckman Realty Inc.

LAKE SUCCESS SHOPPING CENTER ANCHOR OPPORTUNITY

UNION TURNPIKE | NEW HYDE PARK, NY 11040

SITE PLAN | UPPER LEVEL

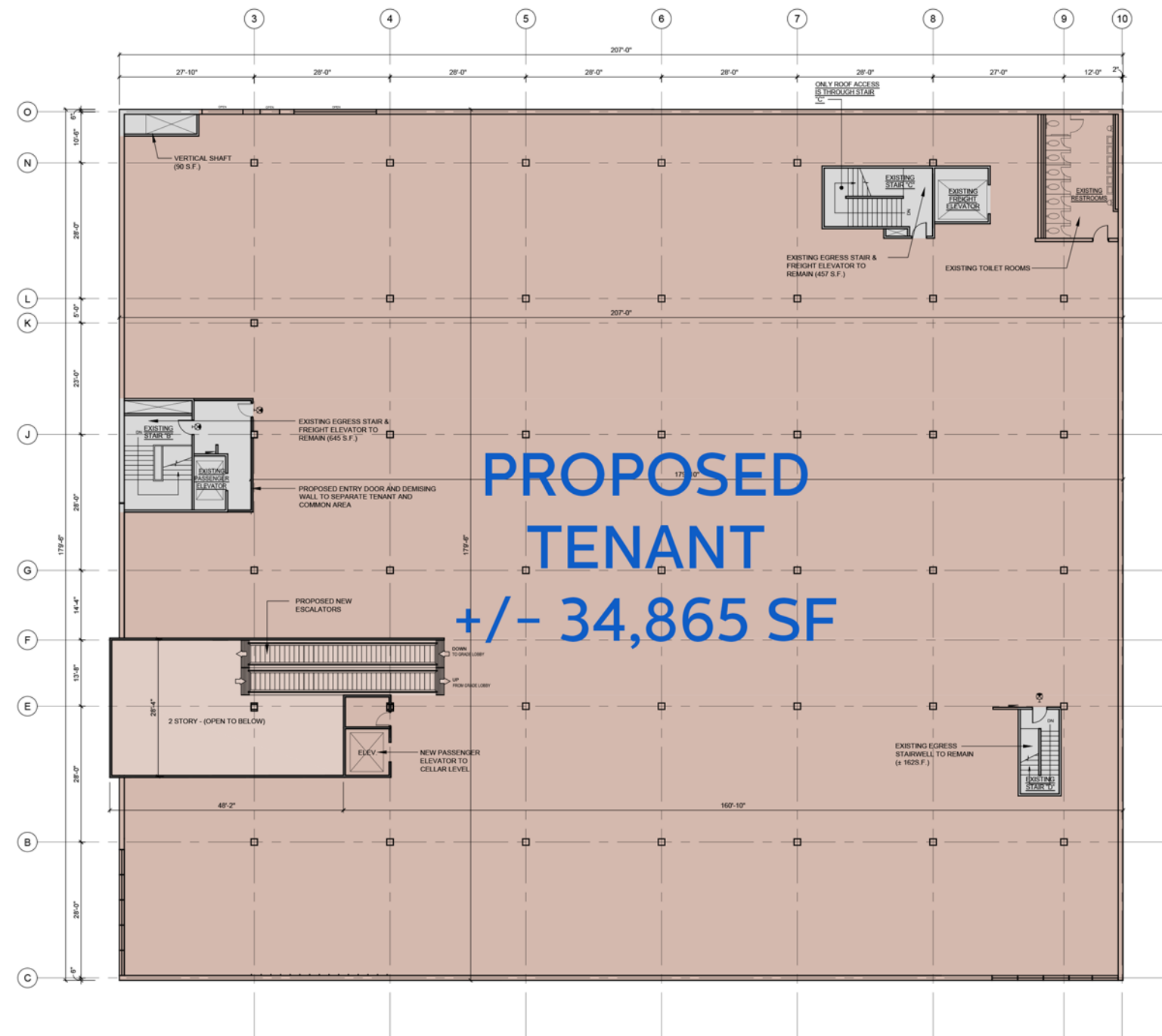

CONTACT EXCLUSIVE BROKERS FOR DETAILS
JESSICA VILMENAY
Executive Managing Director
LIC. Associate RE Broker
jessica@schuckmanrealty.com
KENNETH SCHUCKMAN
President | LIC. RE Broker
ken@schuckmanrealty.com

1983 MARCUS AVENUE, SUITE 102 / LAKE SUCCESS, NY 11042
65 CHALLENGER ROAD, SUITE 305 / RIDGEFIELD PARK, NJ 07660

WWW.SCHUCKMANREALTY.COM
P. 516.496.8888

This information contained herein has been obtained from sources believed reliable. However, we have not verified it and make no guarantee, warranty or representation about it. It is submitted subject to the possibility of errors, omissions, change of price, rental and other conditions, prior sale, lease or financing, or withdrawal without notice. It is your responsibility to independently confirm its accuracy and completeness. Any projections, opinions, assumptions, or estimates used are for example only and they may not represent the current or future suitability, availability or performance of the property. You and your tax and legal advisors should conduct your own investigation of any property and transaction. We may or may not have an exclusive or nonexclusive contractual relationship with a tenant or the owner/landlord of a particular property; and if we do, such relationship shall be fully disclosed to you on a timely basis. Third-party trademarks, service marks, graphics, and logos belong to third parties. You are not granted any right or license with respect to Schuckman Realty Inc.'s trademarks service marks, graphics, and logos or the trademarks service marks, graphics, and logos of any third party. Kenneth Schuckman is Broker of record of Schuckman Realty Inc.