

545 28TH STREET SW
WYOMING, MICHIGAN

OFFICE FOR LEASE
1,040 Square Feet Available



**SIGNATURE
ASSOCIATES**
KNOW SIGNATURE | KNOW RESULTS

PRICE REDUCED



PROPERTY FEATURES

- 4,757 square foot building
- 1,040 available square feet
- Zoned B2
- Built in 1961
- Right off/next to US-131 off-ramp
- Free parking included
- Excellent signage opportunities
- Beautiful common area for waiting clients
- ~~\$20.00/sf~~ \$16.15/sf Gross (\$1,400/mo)
- Tenant responsible for phone, internet and trash



For more information, please contact:

JOE RIZQALLAH

(616) 822 6310

jrizqallah@signatureassociates.com

JEFF DRAFT

(616) 914 6164

jdraft@signatureassociates.com

SIGNATURE ASSOCIATES

1188 East Paris Ave SE, Suite 220

Grand Rapids, MI 49546

www.signatureassociateswm.com

Information is subject to verification and no liability for errors or omissions is assumed. Price is subject to change and listing withdrawal.

545 28th Street SW – Wyoming, Michigan
Office for Lease

1,040
Square Feet
AVAILABLE

Floor Plan

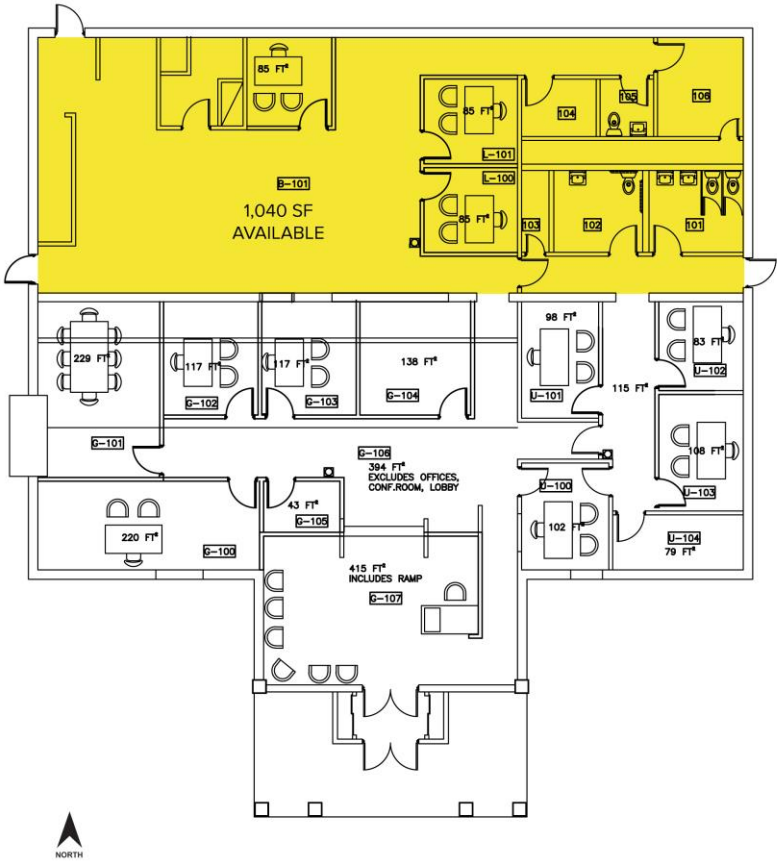

Aerial



For more information, please contact:

JOE RIZQALLAH
(616) 822 6310
jrizzqallah@signatureassociates.com

JEFF DRAFT
(616) 914 6164
jdraft@signatureassociates.com

SIGNATURE ASSOCIATES
1188 East Paris Ave SE, Suite 220
Grand Rapids, MI 49546
www.signatureassociateswm.com

Information is subject to verification and no liability for errors or omissions is assumed. Price is subject to change and listing withdrawal.