

newly upgraded retail

CORNER OF 45TH & LEXINGTON



AT THE NORTH ENTRANCE TO GRAND CENTRAL
2,700 - 4,271 SF AVAILABLE IMMEDIATELY

**Newmark
Knight Frank**

www.ngkf.com/retail



RXR
RXRREALTY.COM

The information contained herein has been obtained from sources deemed reliable but has not been verified and no guarantee, warranty or representation, either express or implied, is made with respect to such information. Terms of sale or lease and availability are subject to change or withdrawal without notice.

460 LEXINGTON AVENUE (AKA 237 PARK AVENUE) AT THE BASE OF A 1.25 MILLION SF OFFICE TOWER

AREA OVERVIEW

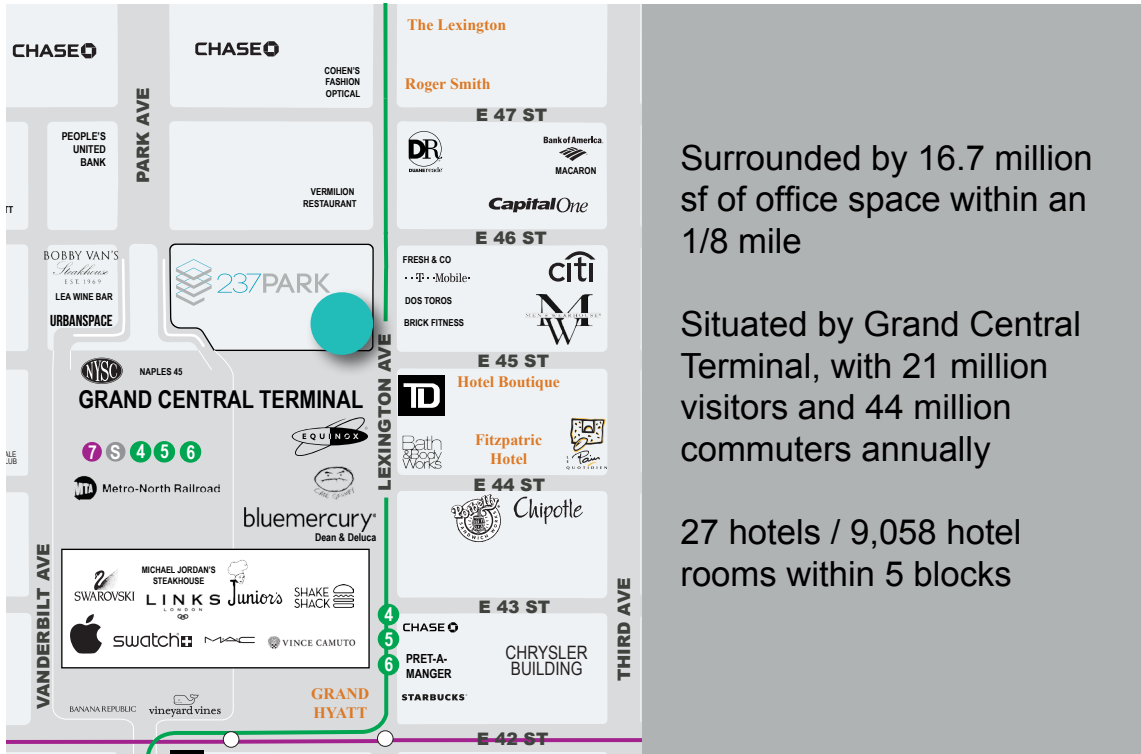

Surrounded by 16.7 million
sf of office space within an
1/8 mile

Situated by Grand Central
Terminal, with 21 million
visitors and 44 million
commuters annually

27 hotels / 9,058 hotel
rooms within 5 blocks

SPECIFICATIONS

Ground floor: A: Approx. 2,700 sf
B: Approx. 1,571 sf
*spaces can be combined

Frontage: Up to 145 feet

Possession: Immediate

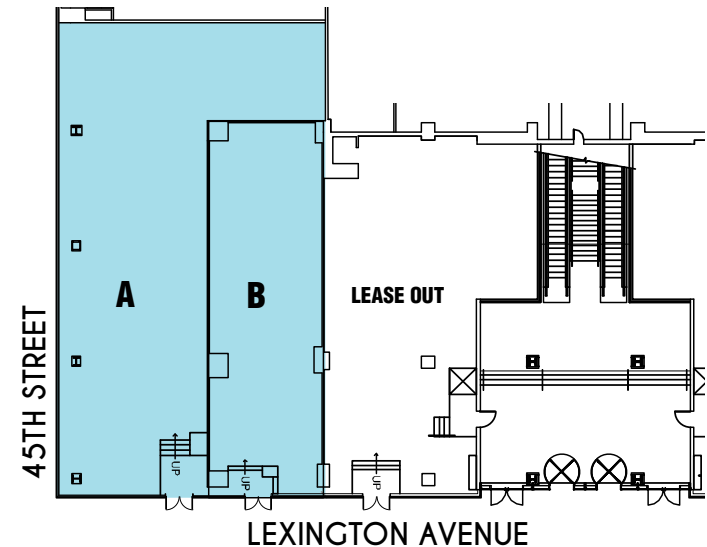

For further information, please contact exclusive agents:

Mark Utreras 646.441.3703
mutreras@ngkf.com

Nevin Danziger 212.850.5430
ndanziger@ngkf.com

Marc Frankel 212.372.2240
mfrankel@ngkf.com

Jeffrey D. Roseman 212.372.2430
jroseman@ngkf.com

**Newmark
Knight Frank**

www.ngkf.com/retail



RXR
RXRREALTY.COM